

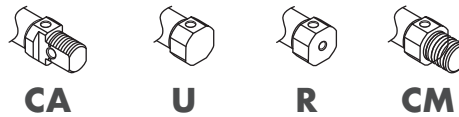

Articulaciones para Cilindro

Tipos de Montaje

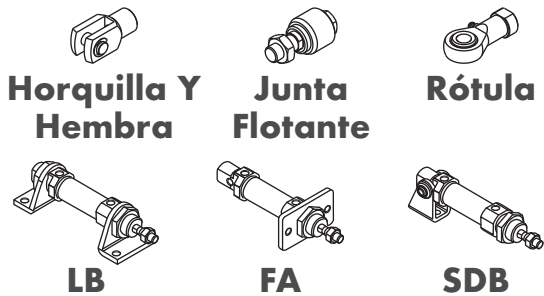

Especificaciones MI

Simbología

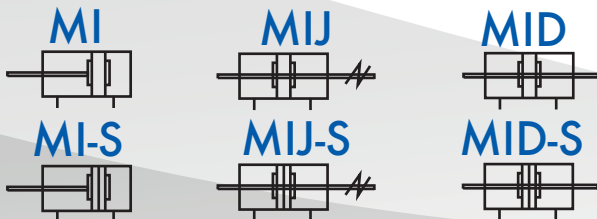

Ø Cilindro (mm)	16	20	25
Tipo de Accionamiento	Doble Efecto		
Fluido	Aire (filtrado a 40 µm)		
Presión de Trabajo	0.15 a 1.0 MPa (22 a 145 psi) (1.5 a 10.0 bar)		
Presión de Prueba	1.5 MPa (215 psi) (15 bar)		
Temperatura °C	-20 a 70		
Velocidad mm/s	30 a 800		
Tolerancia de Carrera	0 a 150 ^{+1.0} ₀ > 0 a 150 ^{+1.4} ₀		
Tipo de Amortiguación	Amortiguación Variable		
Tamaño de Puerto	M5 x 0.8	1/8"	
TPU Sellos Normal -5 a 80 °C			

$$F = P \times A$$

Fuerza

(Empuje del Cilindro) N

=

Presión de Aire

MPa

x

Área de Cilindro

mm²

Fuerza de Trabajo

Unidad: Newton(N)

Ø Cilindro (mm)	Ø Vástago (mm)	Tipo de Accionamiento		Área de Presión (mm ²)	Presión de Trabajo (MPa)						
					0.1	0.2	0.3	0.4	0.5	0.6	0.7
8	4	Doble	Extensión	50.2	5.0	10.1	15.1	20.1	25.1	30.1	35.2
		Efecto	Retracción	37.7	3.7	7.5	11.3	15.1	18.8	22.6	26.4
10	4	Doble	Extensión	78.5	7.9	15.7	23.6	31.4	39.3	47.1	55.0
		Efecto	Retracción	65.9	6.6	13.2	19.8	26.4	33.0	39.5	46.1
12	6	Doble	Extensión	113.0	11.3	22.6	33.9	45.2	56.5	67.8	79.1
		Efecto	Retracción	84.8	8.5	17.0	25.4	33.9	42.4	50.9	59.4
16	6	Doble	Extensión	201.0	20.1	40.2	60.3	80.4	100.5	120.6	140.7
		Efecto	Retracción	172.7	17.3	34.5	51.8	69.1	86.4	103.6	120.9
20	8	Doble	Extensión	314.0	31.4	62.8	94.2	125.6	157.0	188.4	219.8
		Efecto	Retracción	263.8	26.4	52.8	79.1	105.5	131.9	158.3	184.7
25	10	Doble	Extensión	490.6	49.1	98.1	147.2	196.2	245.3	294.4	343.4
		Efecto	Retracción	412.1	41.2	82.4	123.6	164.8	206.1	247.3	288.5
32	12	Doble	Extensión	804.3	80.4	160.9	241.3	321.7	402.2	482.6	563.0
		Efecto	Retracción	691.2	69.1	138.2	207.4	276.5	345.6	414.7	483.8
40	16	Doble	Extensión	1256.6	125.7	251.3	377.0	502.6	628.3	754.0	879.6
		Efecto	Retracción	1055.6	105.6	211.1	316.7	422.2	527.8	633.4	738.9



Fabricación nacional diámetro 16,20 y 25 mm consulta asesor.

Dimensiones MI

Ø Cilindro (mm)	A				AB	AC	AD	AE		AF	B	C	D	DA	E
	Montje Trasero	CA	U	R				CM	CA						
8	86	74			28	46	11.5	9.5	9.5	64	15	8	4	16	M4 x 0.7
10	86	74			28	46	11.5	9.5	9.5	64	15	8	4	16	M4 x 0.7
12	105	88			38	50	12.5	10.5	10.5	75	18	12	6	21	M6 x 1.0
16	111	94	94	111	38	56	12.5	10.5	10.5	82	20	12	6	21	M6 x 1.0
20	126	106	106	126	44	62	14.5	14.5	14.5	95.5	25	16	8	24	M8 x 1.25
25	137	114.5	115	137	50	65	16	16	16	104.5	30	16	10	28	M10 x 1.25
32		125	126	140	58				16.5		34.5	12	28		M10 x 1.25
40		158	158	174	69				22		42.5	16	34		M12 x 1.25

EA	EB	F	FA	G	GA	K	KA	M	MA	MB	p	PA	CA	PB	R
10.5	12	7	3	17	6	4	10	M12 x 1.25	12	12	M5 x 0.8	7	5	5	17
10.5	12	7	3	17	6	4	10	M12 x 1.25	12	12	M5 x 0.8	7	5	5	17
14.5	16	10	5	22	6	6	14	M16 x 1.5	17	17	M5 x 0.8	8	6	6	20
14.5	16	10	5	22	6	6	13	M16 x 1.5	17	17	M5 x 0.8	8	6	6	22
18	19.5	12	6	29	7	8	11	M22 x 1.5	20	20	1/8"	7.5	7.5	7.5	29
20	21.5	17	6	29	7	8	11	M22 x 1.5	22	22	1/8"	8	8	8	33.5
18.5	20	17	6	36	7			M30 x 1.5	30	14	1/8"	9		8/9	37.5
22.5	24	17	7	46	8			M38 x 1.5	35	16	1/4"	12		11.5/12	46.5

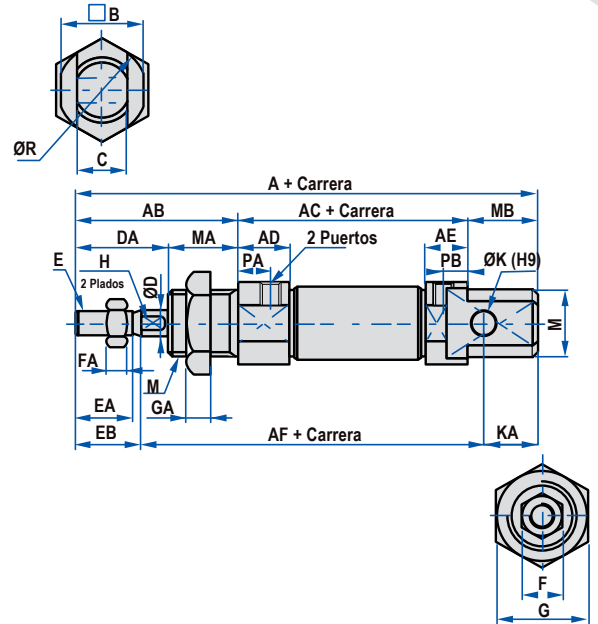

Montajes Traseros

Tipo CA

Tipo U

Tipo R

Tipo CM

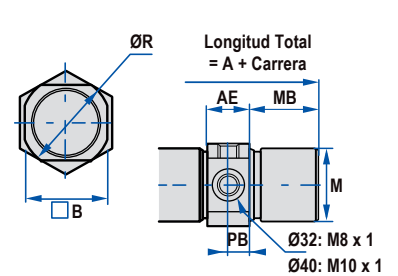
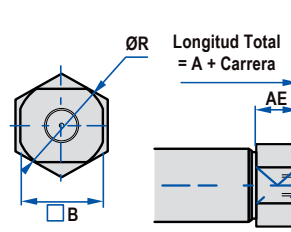
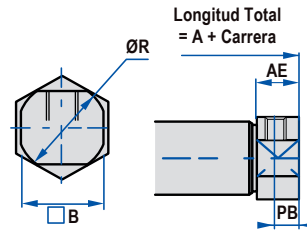
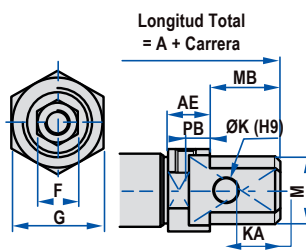

Dimensiones Montajes Traseros

Ø Cilindro (mm)	A				AE		B	F	G	K	KA	M	MB	PB		R
	Montaje Trasero	CA	U	R	CA	U/R/CM								CA	U/CM	
8	86	74			9.5	9.5	15	7	17	4	10	M12 x 1.25	12	5	5	17
10	86	74			9.5	9.5	15	7	17	4	10	M12 x 1.25	12	5	5	17
12	105	88			10.5	10.5	18	10	22	6	14	M16 x 1.5	17	6	6	20
16	111	94	94	111	10.5	10.5	20	10	22	6	13	M16 x 1.5	17	6	6	22
20	126	106	106	126	14.5	14.5	25	12	29	8	11	M22 x 1.5	20	7.5	7.5	29
25	137	114.5	115	137	16	16	30	17	29	8	11	M22 x 1.5	22	8	8	33.5
32		125	126	140		16.5	34.5	17	36			M30 x 1.5	14		8/9	37.5
40		158	158	174		22	42.5	17	46			M38 x 1.5	16		11.5/12	46.5

MID

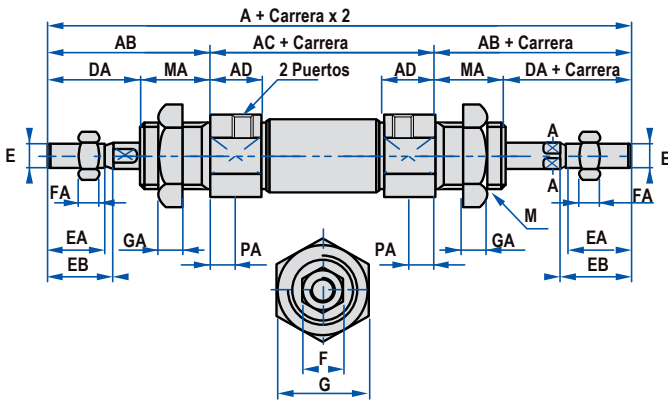

MIJ

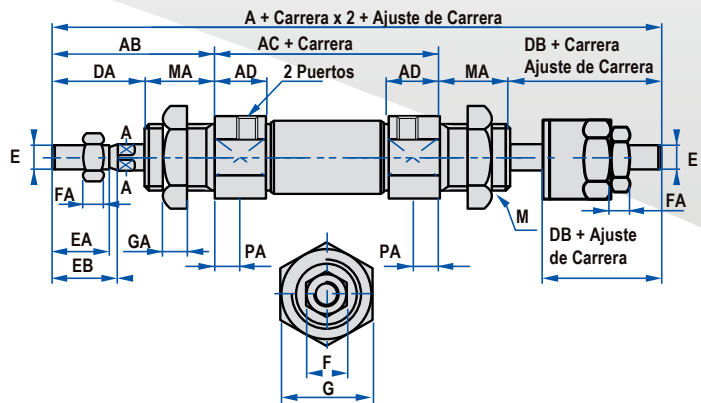

Dimensiones MID Doble Vástago MIJ Ajuste de Carrera

Ø Cilindro (mm)	A (MID)	A (MID)	AB	AC	AD	D	DA	DB	E	EA	EB	F	FA	G	GA	M	MA	P	PA
8	104	103	28	48	11.5	4	16	15	M4 x 0.7	10.5	12	7	3	17	6	M12 x 1.25	12	M5 x 0.8	7
10	104	103	28	48	11.5	4	16	15	M4 x 0.7	10.5	12	7	3	17	6	M12 x 1.25	12	M5 x 0.8	7
12	128	128	38	52	12.5	6	21	21	M6 x 1.0	14.5	16	10	5	22	6	M16 x 1.5	17	M5 x 0.8	8
16	134	134	38	58	12.5	6	21	21	M6 x 1.0	14.5	16	10	5	22	6	M16 x 1.5	17	M5 x 0.8	8
20	150	151	44	62	14.5	8	24	25	M8 x 1.25	18	19.5	12	6	29	7	M22 x 1.5	20	1/8"	7.5
25	165	164	50	65	16	10	28	27	M10 x 1.25	20	21.5	17	6	29	7	M22 x 1.5	22	1/8"	8
32	184	183	58	68	16.5	12	28	27	M10 x 1.25	18.5	20	17	6	36	7	M30 x 1.5	30	1/8"	9
40	227	222	69	89	22	16	34	29	M12 x 1.25	22.5	24	17	7	46	8	M38 x 1.5	35	1/4"	12

Código de Accesorios

Ø Cilindro (mm)	Montajes								Sensor CMSG	Switch DMSG(S)
	LB	FA	SDB	TC	I	Y	F	U		
8	F-MI10LB	F-MI8FA	F-MI8SDB	F-MI10TC	F-M4X070I	F-M4X070Y	F-M4X070F	F-M4X070U		
10										
12	F-MI12LB	F-MA12FA	F-MI12SDB	F-MI12TC	F-M6X100I	F-M6X100Y	F-M6X100F	F-M6X100U		
16									CMSG	DMSG(S)
20	F-MI20LB	F-MA20FA	F-MI20SDB	F-MI20TC	F-M8X125I	F-M8X125Y	F-M8X125F	F-M8X125U		
25					F-M10X125I	F-M10X125Y	F-M10X125F	F-M10X125U		
32	F-MI32LB	-	F-MI32SDB	F-MI32TC						
40	F-MI40LB	-	F-MI40SDB	F-MI40TC	F-M12X125I	F-M12X125Y	F-M12X125F	F-M12X125U		

Ø8 al Ø25

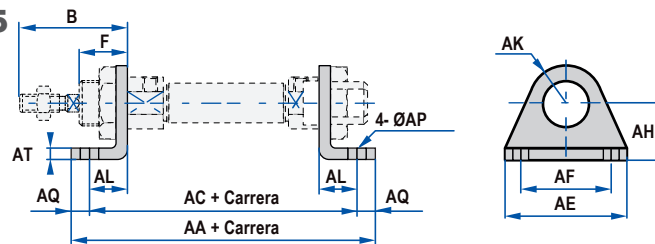

Ø32 al Ø40

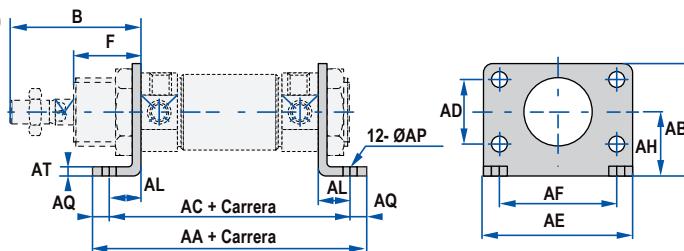

LB

Ø Cilindro (mm)	AA	AB	AC	AD	AE	AF	AH	AK	AL	AP	AQ	AT	B	F
8	78	-	68	-	35	25	16	10	11	4.5	5	2	28	12
10	78	-	68	-	35	25	16	10	11	4.5	5	2	28	12
12	90	-	78	-	42	32	20	13	14	5.5	6	2.5	38	17
16	96	-	84	-	42	32	20	13	14	5.5	6	2.5	38	17
20	112	-	96	-	54	40	25	20	17	7	8	3	44	20
25	115	-	99	-	54	40	25	20	17	7	8	3	50	22
32	110	49	96	28	66	52	28	-	14	7	7	3.5	58	30
40	149	58	129	30	80	60	33	-	20	9	10	3.5	69	35

Ø8 al Ø25

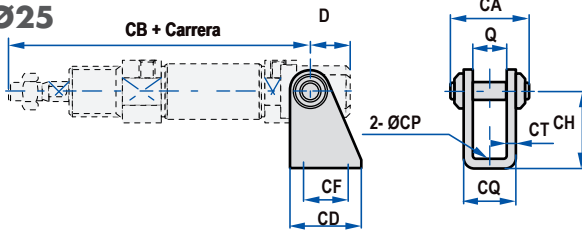

Ø32 al Ø40

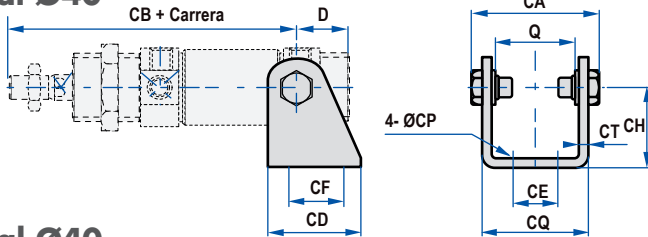

Ø32 al Ø40

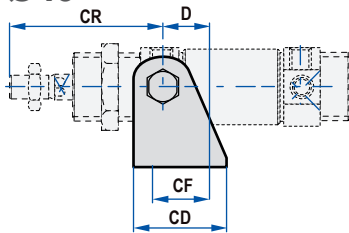

SDB

Ø Cilindro (mm)	D	Q	CA	CB	CD	CE	CF	CH	CP	CQ	CT	CR
8	11	8.1	16.4	76	20	-	12.5	24	4.5	12.1	2	-
10	11	8.1	16.4	76	20	-	12.5	24	4.5	12.1	2	-
12	13	12.1	26	91	25	-	15	27	5.5	16.1	2	-
16	13	12.1	26	98	25	-	15	27	5.5	16.1	2	-
20	16	16.1	35	115	32	-	20	30	7	21.1	2.5	-
25	16	16.1	35	126	32	-	20	30	7	21.1	2.5	-
32	20	34.6	53.6	117	41	20	24	35	7	44.6	3	67
40	27	42.6	65.6	146	52	28	30	40	9	54.6	3	81

Ø8 al Ø25

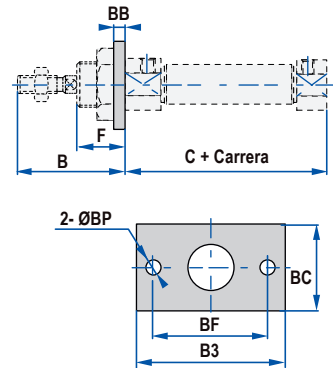

FA

Ø Cilindro (mm)	B	C	BB	BC	BE	BF	BP	F
8	28	46	2	22	40	30	4.5	12
10	28	46	2	22	40	30	4.5	12
12	38	50	3	26	52	40	5.5	17
16	38	56	3	26	52	40	5.5	17
20	44	62	3.5	38	64	50	7	20
25	50	65	3.5	38	64	50	7	22

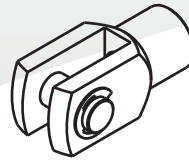

Horquilla Hembra Y

Cómo Ordenar

F M16 x 150 Y

① ② ③ ④

① Código Accesorio	② Rosca de Tornillo	③ Paso de Rosca	④ Código
	M3	050: 0.5mm	Y: Horquilla Hembra
	M4	070: 0.7mm	
	M5	080: 0.8mm	
	M6	100: 1.0mm	
	M8	125: 1.25mm	
	M10		
	M12		

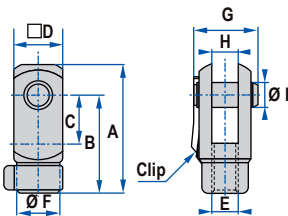

Dimensiones M10

Item	A	B	C	D	F
F-M3X050Y	15.5	12	5	6	6
F-M4X070Y	22	16	8	8	7
F-M5X080Y	28	21	10.2	12	10
F-M6X100Y	32	24	12	12	10
F-M8X125Y	42	32	16	16	14
F-M10X125Y	52	40	20	19	18

Item	E	G	H	I
F-M3X050Y	M3x0.5	9	3	3
F-M4X070Y	M4x0.7	11.5	4	4
F-M5X080Y	M5x0.8	15.5	6.5	5
F-M6X100Y	M6x1.0	16	6	6
F-M8X125Y	M8x1.25	21	8	8
F-M10X125Y	M10x1.25	25	10	10

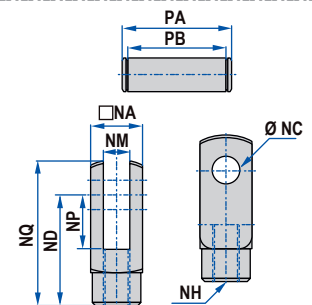

Dimensiones Resto

Item	NA	NC	ND	NP	NQ
F-M12x125Y	25.4	12	48	24	62

Item	NM	NH	PA	PB
F-M12x125Y	12	M12x1.25	32.4	26.2

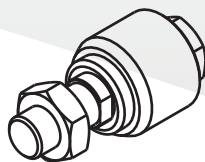

Junta Flotante F

Cómo Ordenar

① Código Accesorio	② Rosca de Tornillo	③ Paso de Rosca	④ Código
F	M16 x 150	F	
	M3	050: 0.5mm	F: Junta Flotante
	M4	070: 0.7mm	
	M5	080: 0.8mm	
	M6	100: 1.0mm	
	M8	125: 1.25mm	
	M10		
	M12		

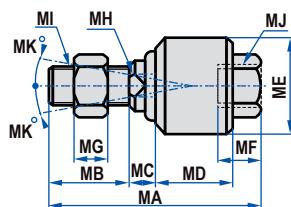

Dimensiones M8 y mayores

Item	MA	MB	MC	MD	ME	MF	MG	MH	MI\MJ	MK
F-M8x125F	51	20	6	17	24	10.5	6	8	M8x1.25	13
F-M10x125F	58	22	7	21	26	11	6	10	M10x1.25	12
F-M12x125F	58	22	8	21	28	11.5	7	12	M12x1.25	12

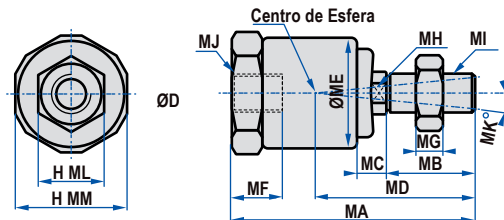

Dimensiones M6 y menores

Item	MA	MB	MC	MD	ME	MF	MG	MH	MI\MJ	ML	MM
F-M3x050F	23.5	7.5	3	15	12.8	5.5	2.4	4	M3x0.5	5.5	13
F-M4x070F	26	9.5	3	17	12.8	6	3	4	M4x0.7	7	13
F-M5x080F	34.5	13.5	3.5	22.8	13.8	8	4	6	M5x0.8	8	14
F-M6x100F	34.5	13.5	3.5	22.8	13.8	8	4	6	M6x1.0	10	14

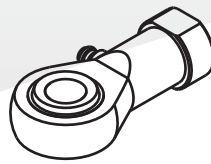

Rótula U

Cómo Ordenar

① Código Accesorio	② Rosca de Tornillo	③ Paso de Rosca	④ Código
F	M16 x 150		
	M3	050: 0.5mm	U: Rótula
	M4	070: 0.7mm	
	M5	080: 0.8mm	
	M6	100: 1.0mm	
	M8	125: 1.25mm	
	M10		
	M12		

M10 y Mayores

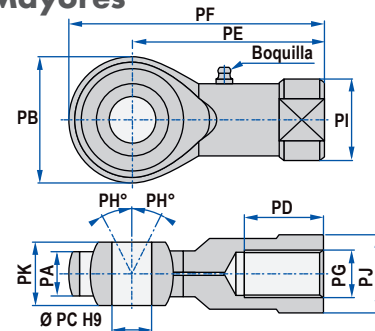

M8 y Menores

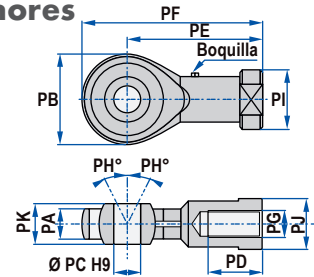

Dimensiones

Item	PA	PB	PC	PD	PE	PF	PG	PH	PI	PJ	PK
F-M4x070U	6	18	5	10	27	36	M4x0.7	13	12.5	10	8
F-M5x080U	6	18	5	10	27	36	M5x0.8	13	12.5	10	8
F-M6x100U	6.8	20	6	12	30	40	M6x1.0	13	13	11	9
F-M8x125U	9	24	8	16	36	48	M8x1.25	13	16	14	12
F-M10x125U	11	26	10	20	43	56	M10x1.25	13	19	17	14
F-M12x125U	12	32	12	22	50	66	M12x1.25	13	22	19	16

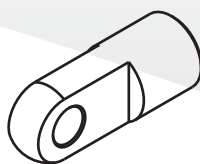

Horquilla I Macho

Cómo Ordenar

F M16 x 150 I

① Código Accesorio	② Rosca de Tornillo	③ Paso de Rosca	④ Código
	M6	100: 1.0mm	I: Horquilla I Macho
	M8	125: 1.25mm	
	M10		
	M12		

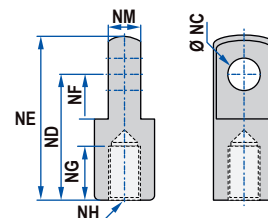

Dimensiones

Item	NC	ND	NE	NF	NG	NH	NM
F-M6x100I	6	21	28	8.5	8	M6x1.0	6
F-M8x125I	8	30	40	11	15	M8x1.25	8
F-M10x125I	10	40	50	15	20	M10x1.25	10
F-M12x125I	12	48	62	24	20	M12x1.25	12

ROMIHN[®]
Automation Technology

Strokmatic[®]
Automation Technology

www.romihn.com.mx

222 940 0313

contactcenter@romihn.com.mx

Ubicaciones

 Puebla	222 531 2925
 CDMX	553 408 1489
 Guadalajara	332 870 3192
 Querétaro	442 668 1414
 Tijuana	664 275 4360
 Santa Catarina	812 254 5561
 Aguascalientes	449 205 4364